

EASTERN ARTERIAL DRIVE

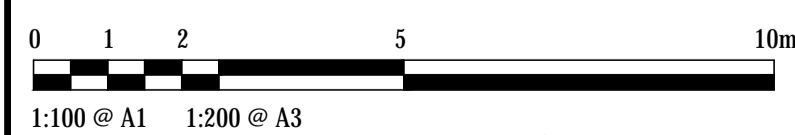
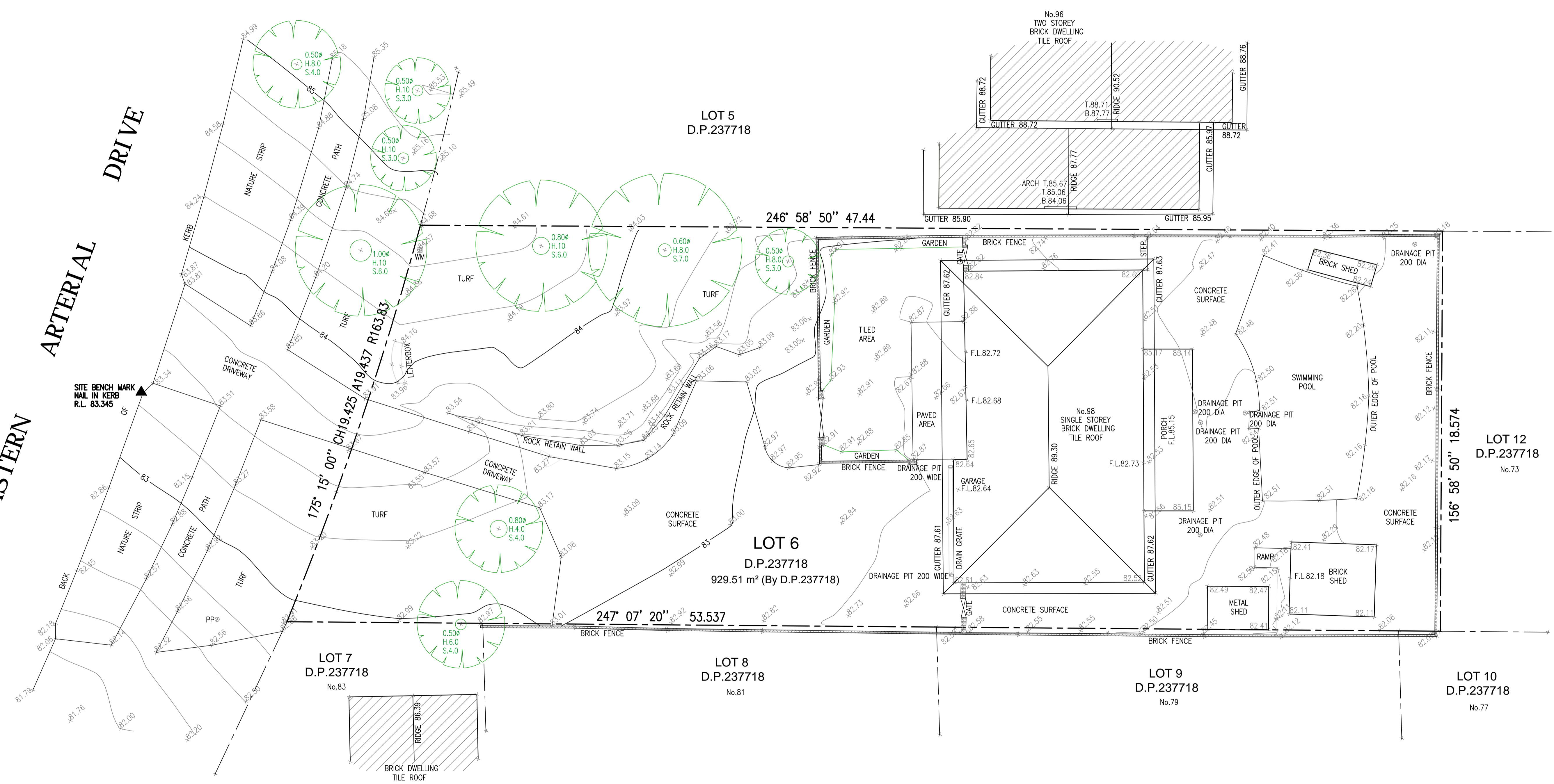

**Disclaimer:**

- This survey is for detail & contour purposes only and the boundaries of the subject properties have not been investigated or marked.
- No "Dial Before You Dig" plans have been reviewed or investigated.
- The Surveyor has made no investigation or independent search for easements of record, encumbrances, restrictive covenants, ownership title evidence, or any other facts that an accurate and current title search may disclose.
- Only visible surface features have been shown. These locations are not intended to be a complete representation of surface utility structures.
- All service details should be confirmed with the relevant service authorities prior to design and construction.
- Boundaries and areas as per deposited plan.
- Adjacent windows facing subject site approximate only.
- Only significant trees shown with approximate dimensions only disclose.
- Subject property is affected by:
  - Land excludes minerals and is subject to reservations and conditions in favour of the Crown - (See Crown Grant(s))

Job No: 10374  
 Locality: ST IVES  
 LGA: KU-RING-GAI

Datum: AHD  
 Origin: PMI6532  
 RL: 129.917  
 Contour: 0.25m  
 Scale: 1:100 @ A1

Surveyor: M.Mackaway  
 Surveyed: 18.10.16  
 Drawn: A.Illango  
 Checked: P.Blackadder  
 Date: 26.10.16  
 Sheet: 1 of 1

**PLAN SHOWING DETAIL SURVEY  
 OVER LOT 6 IN D.P.237718  
 No.98 EASTERN ARTERIAL ROAD, ST IVES**

Client: **SIMON CORNWELL-SMITH**

