

incorrect stair
riser at both top
and bottom run **DO**
NOT align. the
landing jogs out

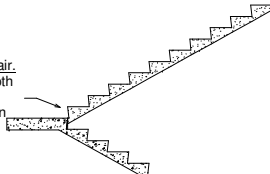

correct stair.
riser at both
top and
bottom run
align



Level 1
0'-0"

Section 1
1/2" = 1'-0"

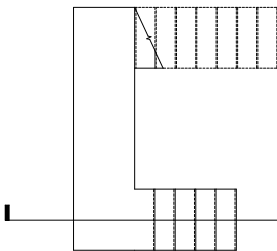

incorrect stair
riser at both top and
bottom run **DO NOT** align.
the landing jogs out

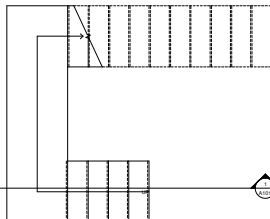

correct stair.
riser at both top and bottom run align