

# PROPOSED CAFE LAYOUT



## FLOORPLAN KEY

1. Southwestern
2. Hearth
3. Global
4. Grab-and-Go Island
5. Hot Beverages
6. Theatre
7. Salad Bar
8. Grab-and-Go Beverages
9. Soup Bar
10. Bakery
11. Deli
12. Self Checkout
13. Cashiers
14. Condiments
15. Recycling
16. Trash
17. Dining Room

**ENTRANCE VIEW (SOUTHWESTERN, HEARTH, THEATRE)**

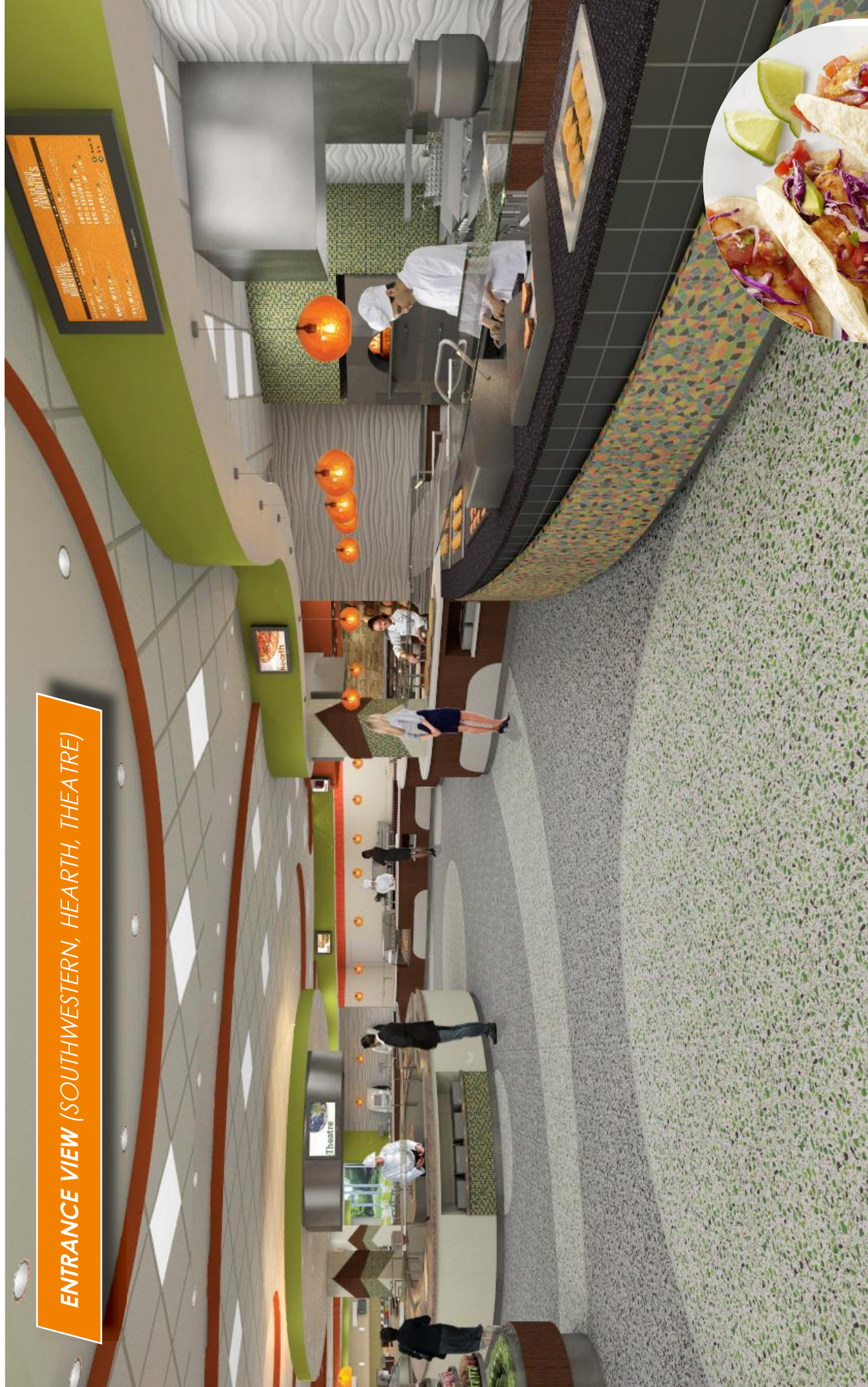

On the Baja coast of California, the Pacific breezes are balmy and life is just as easy as you've heard. Just fresh, clear flavors served in a relaxed atmosphere. This Baja-style fresh Mexican grill, salutes that fresh and honest way of life. We make our salsas fresh daily, and offer them in unlimited quantities. You can taste the pure goodness that comes only from the freshest ingredients



**ENTRANCE VIEW (GRAB-AND-GO, BEVERAGES, THEATRE)**



The perfect spot for everything from a refreshing breakfast, hearty lunch to a re-energizing snack. Global is all about change. Every day, something new is cooking! Bistro style entrees, regional and local favorites, and hand crafted creations paired with complementing fresh vegetables and sides will be served on any given day. Change is inevitable!



## DELI & BAKERY VIEW

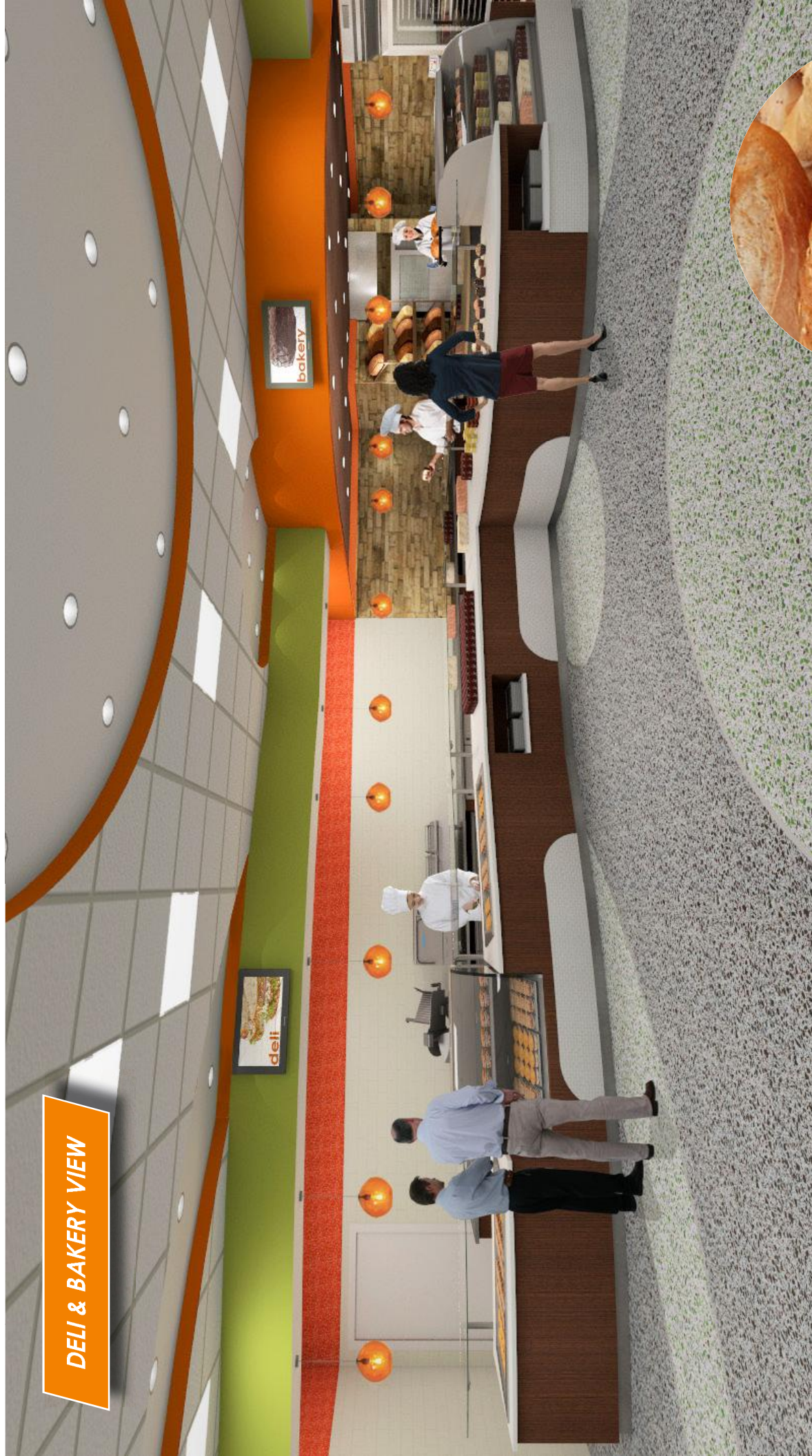

### **Freshly baked goods, daily.**

From pastries to baguettes, this bakery is sure to be a hit. Instead of hiding the bakery (and the incredible smells) in the back, we brought it to the forefront of the cafe for all to see. Deli's serving sandwiches on freshly baked breads are becoming more and more common, as well. Your deli will be supplied with a variety of artisan breads, such as baked foccaccia and sourdough.